

CD08-0003 自紧钻夹头 KEYLESS DRILL CHUCK

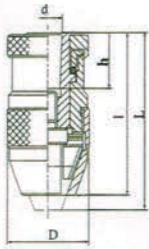

Fig1

重型 Heavy

特点:

- ◇ 本产品执行中华人民共和国机械工业部JB4371.1~4371.3-99标准。
- ◇ 高精度，超强自紧式钻夹头，良好的刚性，持久耐用。
- ◇ 适用于加工中心，数控车床，镗床，铣床等机床。

Features:

- ◇ This product is in conformity with the standard of JB4371.1-4371.3-99 of the Mechanical En-gineering Ministry of China.
- ◇ High precision super drill chucks. Good rigidity & High durability.
- ◇ Suitable for Heavy duty & Extra heavy duty. For Machining center, Digital control machine-tool, Boring lathe and Milling machine.

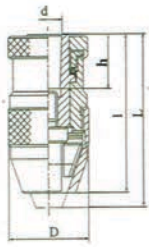

Fig2

轻型 Light

特点:

- ◇ 本产品执行中华人民共和国机械工业部JB4371.1~4371.3-99标准。
- ◇ 体积小，重量轻，操作安全，简便。
- ◇ 广泛适用于各类钻床，铣床，车床，床及手工具。

Features:

- ◇ This product is in conformity with the standard of JB4371.1-4371.3-99 of the Mechanical En-gineering Ministry of China.
- ◇ Small volume, Little weight, Extremely safe and Easy operation.
- ◇ For Various drill machines, Milling machine, Lathe, Boring Lathe and Electric hand tool.

主要技术参数 MAIN SPECIFICATIONS

型号 Model No.	夹特范围 Capacity mm	锥孔号 Taper	Fig	d	h	D	L	l
J0106	0.3-4	JT0	Fig1	6.350	11.112	φ28	50	45
	0.5-6	B10	Fig1, Fig2	10.094	14.5	φ35	67	61
		B12	Fig1, Fig2	12.065	18.5			
	1/64" ~ 1/4"	JT0	Fig1, Fig2	6.350	11.112			
JT1		Fig1, Fig2	9.754	16.669				
J0108	0.5-8	B12	Fig1	12.065	18.5	φ42	91	84
			Fig2				86	78
		B16	Fig1	15.733	24.0		91	84
			Fig2				86	78
	1/64" ~ 5/16"	JT2	Fig1	14.199	22.225		91	84
			Fig2				86	78
		JT33	Fig1	15.850	25.400		91	84
			Fig2				86	78
J0110H	1-10	B12	Fig1	12.065	18.5	91	84	
			Fig2			86	78	
		B16	Fig1	15.733	24.000	91	84	
			Fig2			86	78	
	1/32" ~ 3/8"	JT2	Fig1	14.199	22.225	91	84	
			Fig2			86	78	
		JT33	Fig1	15.850	25.400	91	84	
			Fig2			86	78	
J0113H	1-13	B12	Fig1	12.065	18.5	φ48	106	97
			Fig2			φ44	97	88
		B16	Fig1	15.733	24.0	φ48	106	97
			Fig2			φ44	97	88
	1/32" ~ 1/2"	JT2	Fig1	14.199	22.225	φ48	106	97
			Fig2			φ44	97	88
		JT33	Fig1	15.850	25.400	φ48	106	97
			Fig2			φ44	97	88
1/32" ~ 1/2"	JT6	Fig1	17.170	25.400	φ48	106	97	
J0116H	1-16	B16	Fig1	15.733	24.0	φ53	109	101
			Fig2			φ48	102	92
	3-16	B18	Fig1	17.780	32.0	φ53	109	101
			Fig2			φ48	108	98
	1/32" ~ 5/8"	JT6	Fig1	17.170	25.400	φ53	109	101
			Fig1			φ53	109	101
	1/8" ~ 5/8"	JT3	Fig1	20.599	30.956	φ48	108	98
			Fig2			φ48	102	92
17.170	25.4000	φ48	102	92				
J0120H	5-20	B22	Fig1	21.793	40.5	φ62	129	119
			Fig2			21.3	30.5	φ53
	3/16" ~ 3/4"	JT3	Fig1	20.599	30.956	φ62	129	119
			Fig2			φ53	115	103