

高精度ER铣夹头系列 HIGH ACCURACY ER MILLING CHUCK SERIES

CD0102-30 BT、SK(DIN69871)、NT 刚性伸缩攻牙本体 BT、SK(DIN69871)、NT RIGID TENSION AND COMPRESSION TAPER HOLDER



- ◎材质20CrMnTi或SCM415;
- ◎硬度 $58 \pm 2\text{HRC}$; 渗碳深 > 0.8 ;
- ◎伸长及收缩可达5mm, 搭配刚性ER攻丝筒夹;
- ◎刀柄柄体做 -196°C 超长深冷处理及热时效处理;
- ◎外观涂层处理;

- ◎Material:20CrMnTi/SCM415 ;
- ◎Hardness: $58 \pm 2\text{HRC}$; Carbon depth > 0.8 ;
- ◎Tension and compression can reach up to 5mm with rigid ER tapping collet;
- ◎chuck shank do -196°C super-long cryogenic treatment and thermal aging treatment;
- ◎coating surface.

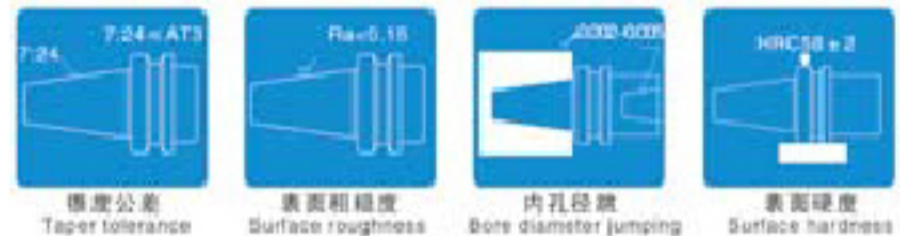
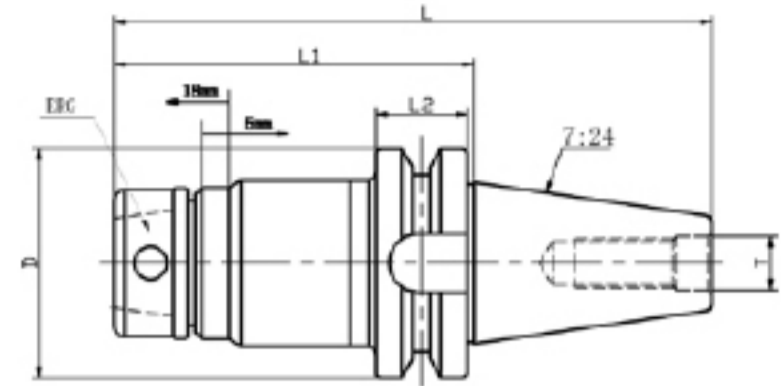

型号 Model No.	攻牙范围 Tapping range	D	L	L1	L2	T	COLLET
BT30-TER16	M3-M10	46	149	100.6	20	M12	ER16G
BT30-TER20	M3-M17	46	151	102.6	20	M12	ER20G
BT30-TER25	M3-M22	46	153	104.6	20	M12	ER25G
BT30-TER32	M3-M27	46	156	107.6	20	M12	ER32G
BT40-TER16	M3-M10	63	161	95.6	25	M16	ER16G
BT40-TER20	M3-M17	63	163	97.6	25	M16	ER20G
BT40-TER25	M3-M22	63	165	99.6	25	M16	ER25G
BT40-TER32	M3-M27	63	168	102.6	25	M16	ER32G
BT50-TER16	M3-M10	100	207	105.2	35	M24	ER16G
BT50-TER20	M3-M17	100	209	107.2	35	M24	ER20G
BT50-TER25	M3-M22	100	211	109.2	35	M24	ER25G
BT50-TER32	M3-M27	100	214	112.2	35	M24	ER32G
SK40-TER16	M3-M10	63.55	152	86.5	15.9	M16	ER16G
SK40-TER20	M3-M17	63.55	154	88.5	15.9	M16	ER20G
SK40-TER25	M3-M22	63.55	156	90.5	15.9	M16	ER25G
SK40-TER32	M3-M27	63.55	159	93.5	15.9	M16	ER32G
SK50-TER16	M3-M10	97.5	189	86.5	15.9	M24	ER16G
SK50-TER20	M3-M17	97.5	191	88.5	15.9	M24	ER20G
SK50-TER25	M3-M22	97.5	193	90.5	15.9	M24	ER25G
SK50-TER32	M3-M27	97.5	195	93.5	15.9	M24	ER32G
NT40-TER16	M3-M10	63	174	108.6	10	M16	ER16G
NT40-TER20	M3-M17	63	176	110.6	10	M16	ER20G
NT40-TER25	M3-M22	63	178	112.6	10	M16	ER25G
NT40-TER32	M3-M27	63	181	115.6	10	M16	ER32G
NT50-TER16	M3-M10	100	209	110.6	12	M24	ER16G
NT50-TER20	M3-M17	100	211	112.6	12	M24	ER20G
NT50-TER25	M3-M22	100	213	114.6	12	M24	ER25G
NT50-TER32	M3-M27	100	216	117.6	12	M24	ER32G